

# Coleman Irons, Model Nos. 1 and 2

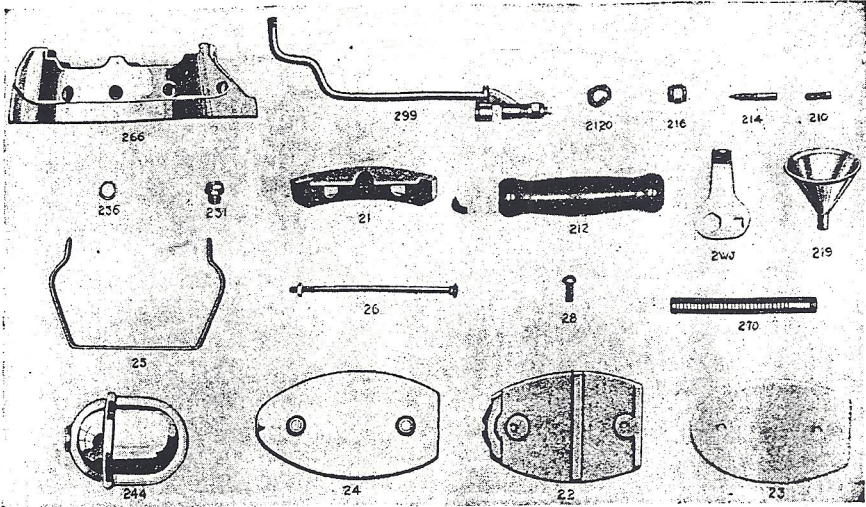

## PARTS FOR COLEMAN IRON, MODEL No. 2

Parts Nos.				Name of Part	Net Retail Price
No. 1		No. 2			
New No.	Old No.	New No.	Old No.		
210	6	210		210—Lid Set Screw .....	.12
600-399				.....—Burner, Valve, Generator & Fount Complete Assembled .....	3.45
600-657	2			.....—Valve & Generator Complete Assembled.....	1.50
601-136	7	601-136		236—Filler Plug Gasket.....	2 for .06
601-159	14	601-159		244—Fount (Less Filler Plug).....	1.26
601-164	8	601-164		231—Filler Plug Complete .....	.24
601-370	12	601-370		270—Burner .....	.60
		601-399		222—Burner, Valve, Generator & Fount Complete Assembled .....	3.45
601-614	5	601-614		214—Valve Stem .....	.24
601-616	4	601-616		216—Pack Nut .....	.24
601-620	3	601-620		2120—Valve Stem Packing.....	2 for .09
601-653		601-653		.....—Valve Stem Complete.....	.60
		601-657		299—Valve & Generator Complete Assembled.....	1.50
601-950	11	601-950		2WJ—Wrench .....	.15
603-440		603-440		220—Stand .....	.24
603-446	15	603-446		25—Handle Bracket .....	.15
603-451	13	603-451		26—Handle Bolt (1/8"x5" Carriage).....	.06
603-940	19	603-940		219—Funnel .....	.18
604-445	10	604-445		212—Iron Handle .....	.21
	1			266—Body Base .....	1.32
	9			21—Deflector Plate .....	.30
	16B			22—Lid Plate (Lower).....	.45
	16T			24—Lid Plate (Upper).....	.36
	17			23—Lid Plate Asbestos Liner.....	.18
	18			28—Bolt (Handle Bracket to Lid Plate (Lower) (1/4"x5/8" U. S. S. R. H.).....	.12
				27—Lid Extension Arm.....	.12

Model No. 1 was equipped with black Handle and without holes in the side of the Body Base. All parts listed under New Nos., both for Model Nos. 1 and 2, are interchangeable with the following exceptions: Model No. 1, Part Nos. 600-399 and 600-657; Model No. 2, Part Nos. 601-399 and 601-657. All parts listed under Old Nos., both for Model Nos. 1 and 2, only, are not interchangeable, with following exceptions: Model No. 1, Part No. 18 Model No. 2, Part No. 28.