

PARTS LIST

395

**INSTANT LIGHTING GASOLINE
CABIN AND TRAILER STOVE
HOT PLATE (THREE BURNER)**

COLEMAN STOVES

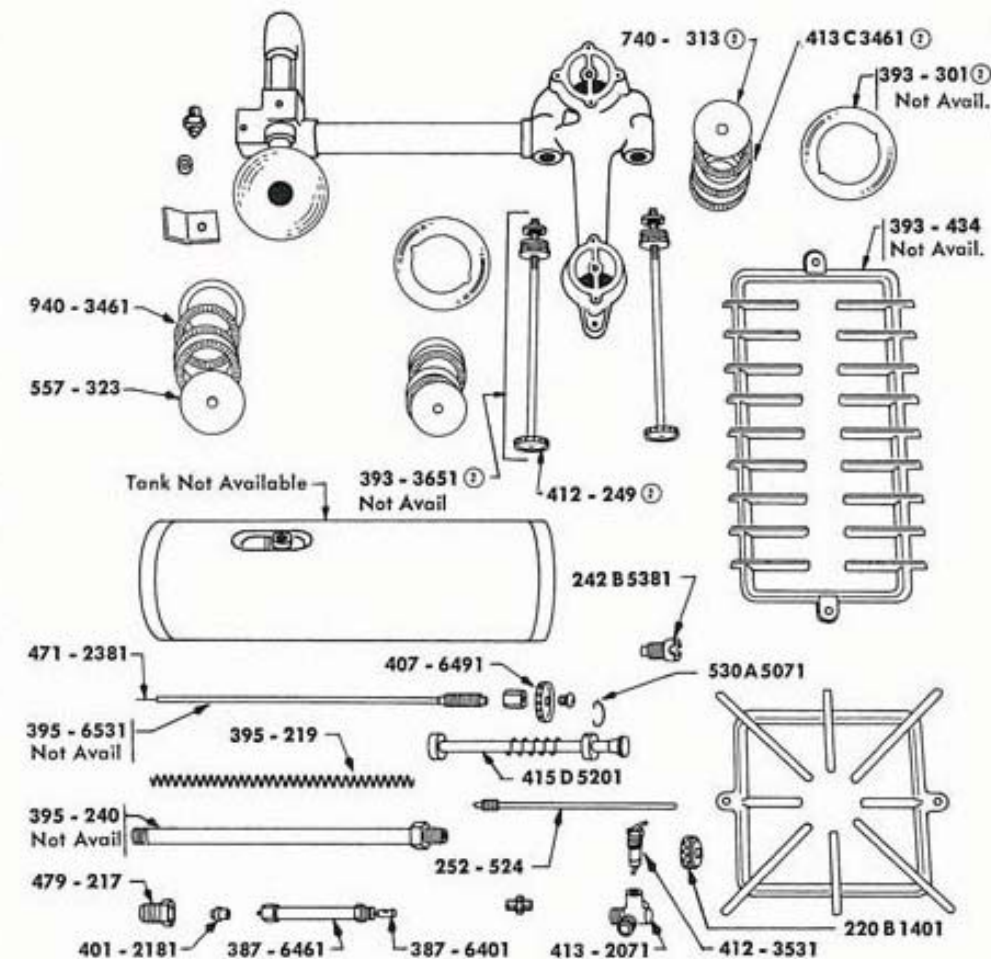

Parts Not Shown:

- 118 B 1361 Gasket
- 216 - 5091 Pump Cup
- 242 - 6201 Packing
- 395 - 6601 Valve and Generator
- 1048 - 0006 Machine Screw

Ⓢ Quantity of Parts Used in Assembly

MODEL 395 SHOWN



Model 395
(Discontinued)

STOVES

MODEL	FINISH (Enamel)		TANK CAPACITY (In Pints)	DIMENSION (Without Tank in Inches)		
	Top & Grate	Body		Height	Width	Depth
395	Black	Ivory	5	7½	23¼	17

PART NO.	DESCRIPTION
17 - 059	Screw (Replaced by 1048-0006)
118 B 1361	Gasket (Filler Cap)
216 - 5091	Pump Cup
216 - 532	Stem (Replaced by 252-524)
220 B 1401	Filler Cap
242 - 6201	Packing (Valve Stem)
242 B 5381	Check Valve
252 - 524	Air Stem
387 - 6401	Block and Needle Ass'y
387 - 6461	Tube Ass'y (Fuel and Air)
393 - 301	Burner Bowl (Aux.) - Not Avail.
393 - 3651	Valve Stem (Aux.) - Not Avail.
393 - 434	Grate (Aux.) - Not Available
395 - 219	Generator Coil
395 - 240	Tube (Gen.) - Not Available
395 - 6531	Stem Ass'y - Not Available
395 - 6601	Valve and Generator (Complete)

PART NO.	DESCRIPTION
401 - 2181	Gas Tip (Marked "B")
407 - 6491	Wheel (Valve)
412 - 249	Wheel (Valve)
412 - 3531	Stem (Lighter)
412 - 5071	Clip (Pump Cap) (Replaced by 530A5071)
413 - 2071	Valve Body
413 C 3461	Cap and Fillers (Aux.)
415 D 5201	Plunger Ass'y (Pump)
471 - 2381	Needle and Holder
479 - 217	Protector (Tip)
530 A 5071	Clip (Pump Cap)
557 - 323	Cap (Burner) (Master)
740 - 313	Cap (Burner) (Aux.)
940 - 3461	Filler Ass'y (Master)
1048 - 0006	Machine Screw (#4-36 x ¾ Rd. Hd. Stl.)