

PARTS LIST

237, 237A

ALCOHOL GENERATING
KEROSENE
SINGLE MANTLE

COLEMAN LANTERNS

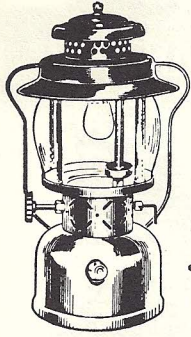

Model 237
Discontinued

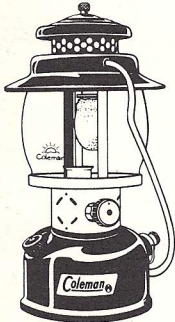

Model 237A

LANTERNS

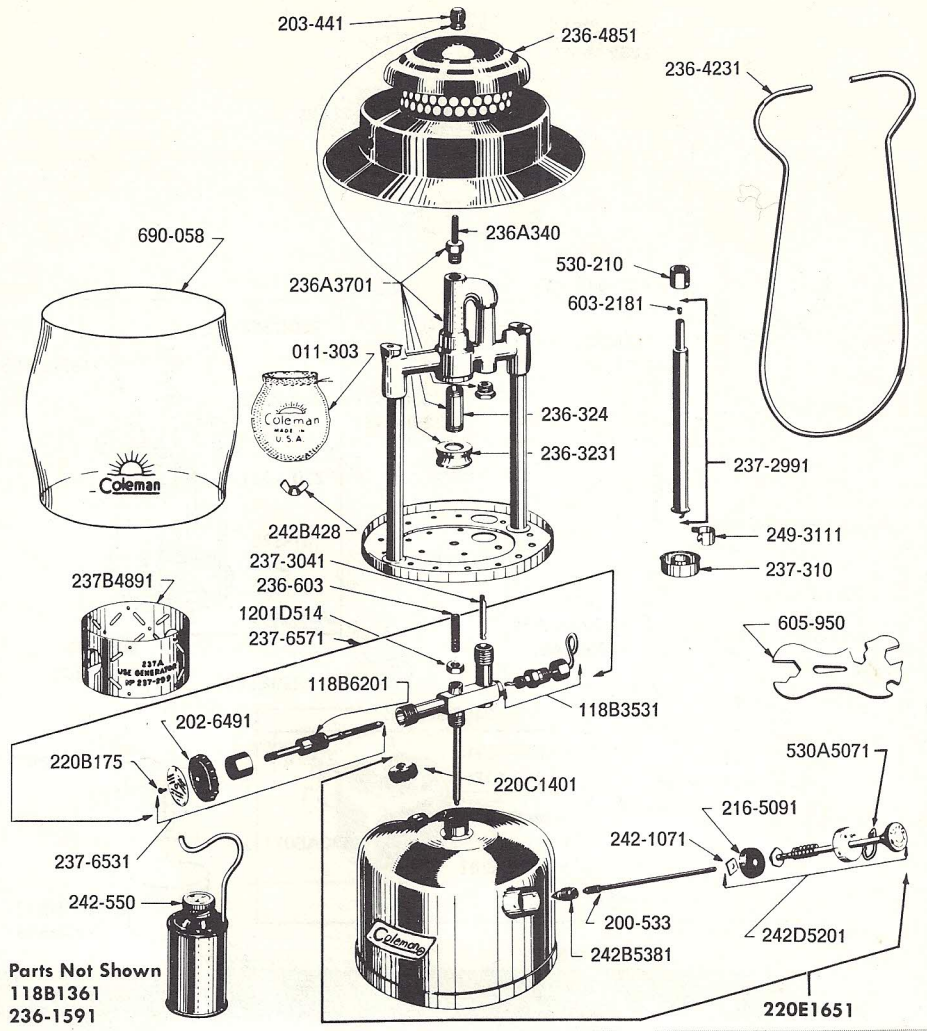

Parts Not Shown
118B1361
236-1591

MODEL 237A SHOWN

Model	FINISH		LANTERN HEIGHT	FUEL CAPACITY
	Fount	Ventilator (Porcelain)		
237	Nickel	Green (7 3/8")	14 1/2"	2 Pints
237A	Green	Green (7 3/8")	14 1/2"	2 Pints

PART NO.	DESCRIPTION	USED ON	PART NO.	DESCRIPTION	USED ON
8B197	Enamel, Fount, Green	237A	237 - 2991	Generator	
011 - 303	1111 Mantle		237 - 3041	Eccentric Block	
118B1361	Filler Cap Gasket (for Cap with Disc)		237 - 310	Preheater Cup	
118B3531	Tip Cleaner Stem		237 - 5601	Fount - Replaced by 220E1651.	237A
118B6201	Valve Stem Packing		237 - 6531	Stem Assembly	
200 - 533	Air Stem		237 - 6571	Valve (Less Generator)	
202 - 6491	Valve Wheel		237A4891	Base Rest	237
203 - 441	Ball Nut		237B4891	Base Rest	237A
216 - 5091	Pump Cup		242 - 550	Filling Can	
220 - 6361	Filler Cap Gasket & Disc Ass'y. - Discontinued		242 - 1071	Push On Nut (used with 242D5201 Plunger)	
220B175	Self-Tapping Screw (#4 - 40 x 5/16")		242B428	Wing Nut	
220C1401	Filler Cap, Complete		242B5381	Check Valve	
220E1651	Fount, Complete		242D5201	Pump Plunger Assembly	
236 - 1591	Fount (Less Pump & Filler Cap) - Nickel Pltd.		249 - 3111	Spring Clip (Preheater Cup)	
236 - 3231	Burner Cap and Screen		530 - 210	Jamb Nut	
236 - 324	Burner Tube		530A5071	Pump Cap Clip	
236 - 4231	Bail		605 - 950	Wrench (Large)	
236 - 4851	Ventilator		690 - 058	660 Clear Pyrex Globe	
236 - 603	Connecting Stud		1124D0203	Sheet Metal Screw, Pump Cap	237
236A340	Ventilator Rod		1059D1004	Machine Screw (for Cap with Disc)	
236A3701	Burner Assembly, Complete		1201D514	7/16" Hex Nut (1/4" - 20)	