

## HOW TO USE YOUR



## 442A TWO BURNER CAMP STOVE



### **Always Use the Right Kind of Fuel**

Substances in gasoline which do not vaporize will form carbon in the generator of your stove. The length of service you get from your stove and generator depends greatly upon the kind of fuel you have.

Use *only* clean, "white" Gasoline (Coleman S & L Fuel, for example); never use fuel containing lead compounds or lubricating oils. Store your fuel in a clean, closed metal container. (Glass containers are dangerous — may break.)

If Coleman S & L Fuel or ordinary "white" gasoline is not readily available, most oil companies will gladly tell you where to obtain it.

### **To Open Stove**

Pull supporting legs down until they snap into position. Raise lid until it stops in upright position. If it is windy, shield the burners by placing the wire clips attached to the wind baffles in slots at each end of the stove.

Raise the grate, and remove tank assembly.

### **To Fill Tank** (see illustration at right)

Close generator valve (1) by turning valve wheel to the right. Unscrew filler cap (2). With tank in level position, fill with clean, fresh fuel. Tank

holds 3 pints. Replace filler cap and tighten with fingers.

### **To Pump Air Pressure into Tank**

Generator valve and *filler cap must be closed*. Turn pump plunger handle (3) two complete turns to the left. Place thumb over the small hole in handle and pump 35 to 50 full strokes of air into the tank. Then turn pump plunger handle to the right until tight.

### **To Place Tank and Generator in Position**

Push carrying handle up out of the way. Insert

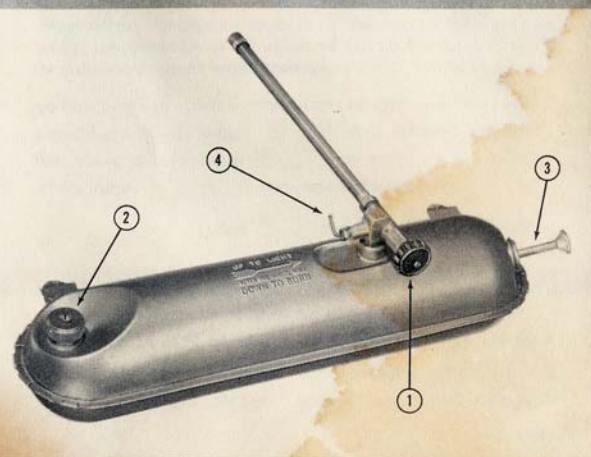



the generator into large hole at right end of stove, then into opening in mixing chamber. Engage the hanger brackets into slots in front of case to support the tank.

#### **To Light Master Burner**

Be sure auxiliary valve is closed. Turn instant-light lever (4) to "UP TO LIGHT" position. Hold a lighted match above the master burner and turn valve wheel (1) wide open to left. Operate burner *full open* approximately one minute. When flame is quite blue, turn instant-light lever (4) to "DOWN TO BURN" position. Flame can be adjusted by turning valve wheel. Add air pressure to tank to increase force or efficiency of flame.

#### **To Light Auxiliary Burner**

After the main burner has been lighted, the auxiliary burner may be lighted by extending valve handle through opening at end of stove. Now hold a match above the burner and open the auxiliary valve. Flame can be adjusted as desired. Master burner may require adjustment after lifting auxiliary burner.

#### **To Shut Off Auxiliary Burner**

Turn auxiliary burner valve to right until closed.

#### **To Shut Off Main Burner**

On master burner, turn instant-light lever (4) to "UP TO LIGHT" position and let burn one minute. (This cleans heavier parts of fuel from the generator to protect the instant-lighting feature). Now turn the valve wheel (1) to the right and tighten. The burner may operate a few seconds until gas in the generator is gone.

#### **To Pack Stove**

Reverse the procedure followed in opening stove. The tank and generator go in the left end of the stove as you face it. Lock lid in place and lay stove down with bottom side up. To unlock the legs, push in on the ends, then slide them into the frame.



#### **STOVE & LANTERN FUEL**

especially blended for top performance, and longer burning time in Coleman products. Burns cleanly—no soot, smoke, or odor. Contains rust and gum inhibitors which protect against clogging, rust, and corrosion. Available in quart and gallon sizes in reuseable, leak-proof can with built-in pouring spout. Does not deteriorate in the can.

**GENERATOR** changes liquid fuel into vapor, and is the heart of your Coleman Camp Stove. Should it fill with carbon impairing the stove's efficiency, replace with another genuine factory-tested, precision-built Coleman Generator, No. 413A5621. To insure trouble-free outdoor cooking, buy a spare generator today, and keep it handy.

other Coleman products to  
add to your outing fun!



#### **WORLD'S FINEST SNOW-LITE® PICNIC JUGS**

100% insulated with Thermo-Lock styrene. Exclusive one-piece molded liner is smooth, easy to clean, lightweight, unbreakable, won't chip or crack, will withstand temperatures of boiling water or freezing ice. Tough Royalite base is rust- and corrosion-proof. Available with Pitcher-Pour or bail handle with Spout or nylon spring-loaded, push-button faucet. Your choice of three beautiful colors.

#### **WORLD'S FINEST SNOW-LITE® COOLERS**

Lightweight, yet will withstand the most rugged abuse. Snow-Lite linings are strong and durable, rust and leak-proof, stain resistant, will not retain odors. They wipe clean instantly. Thermo-Lock styrene insulation holds cold up to 45% longer than ordinary coolers. Tough Royalite bottoms won't scuff, rust, corrode, or stain. Steel or aluminum models available in two sizes and four beautiful colors.



#### **WORLD FAMOUS COLEMAN LANTERNS**

A Coleman lantern stretches days to give more hours of fun while hunting, fishing, camping, or vacationing. It's a life saver for use during emergencies. It keeps camps bright as day. Floods a 100-ft. area with strong light, bright as a 300-watt electric bulb, and keeps burning until morning all on a few cents worth of fuel. It's windproof, stormproof, bug-proof. Available in one and two-mantle models.



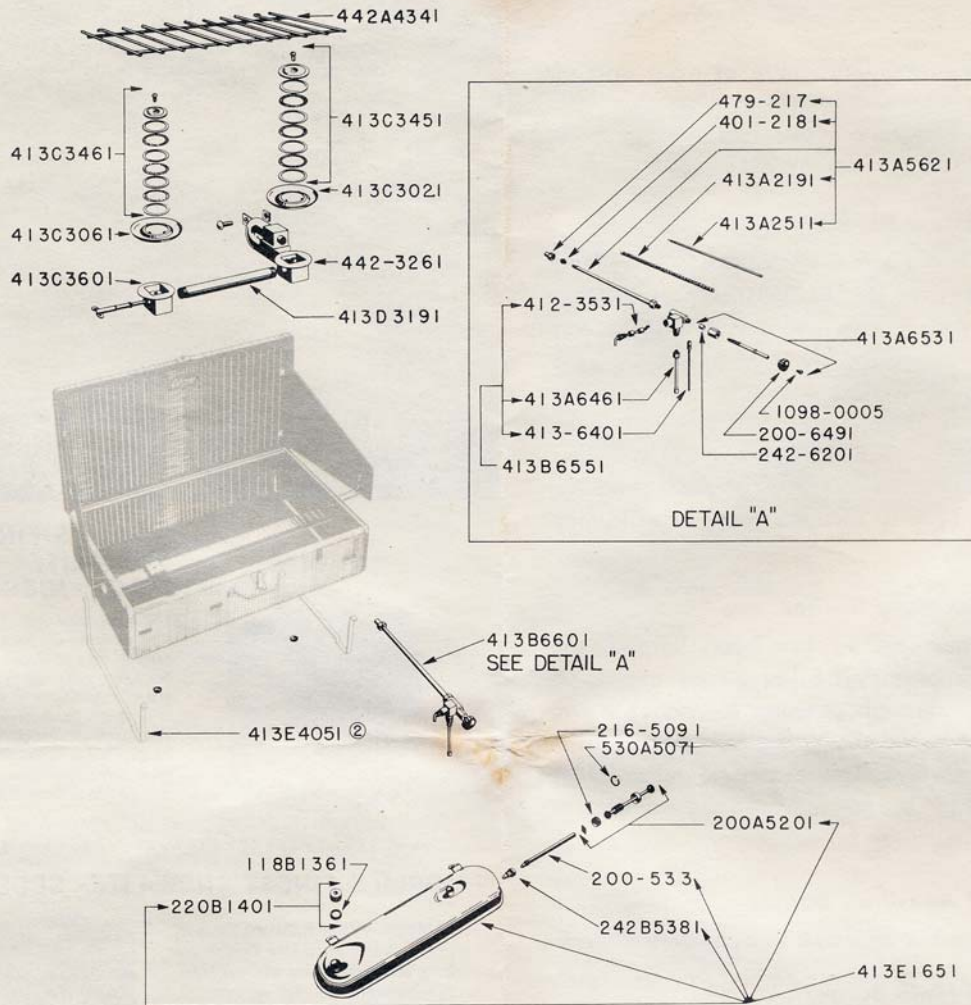

② Quantity of Parts Used in Assembly

**PARTS  
LIST FOR  
COLEMAN  
CAMP  
STOVE  
442A**

PART NO.	DESCRIPTION	PART NO.	DESCRIPTION	PART NO.	DESCRIPTION
118B1361	Gasket (Filler Cap)	413A5621	Generator	413C3601	Valve Stem (Aux. with Manifold)
200-533	Air Stem Assembly	413A6461	Tube Assembly (Fuel and Air)	413D3191	Pipe (Manifold)
200-6491	Wheel (Valve)	413A6531	Stem Assembly	413E1651	Tank
200A5201	Plunger Ass'y (Pump)	413B6551	Valve (Less Generator and Valve Stem)	413E4051	Leg
216-5091	Leather (Pump)	413B6601	Valve and Generator (Complete)	442-3261	Master Burner Body
220B1401	Filler Cap	413C3021	Burner Bowl (Master)	442A4341	Grate
242-6201	Packing (Valve Stem)	413C3061	Burner Bowl (Aux.)	479-217	Protector (Tip)
242B5381	Check Valve	413C3451	Cap and Fillers (Master)	530A5071	Clip (Pump Cap)
401-2181	Gas Tip (Marked B)	413C3461	Cap and Fillers (Aux.)	1098-0005	Machine Screw (No. 4 36x1/4" Brass Rd. Hd.)
412-3531	Stem (Lighter)				
413-6401	Block and Needle Ass'y				
413A2191	Coil (Generator)				
413A2511	Needle Assembly				

See your Coleman Dealer for Repair Parts



## GENERAL SUGGESTIONS

**KEEP BURNER CLEAN.** An obstruction, such as a burned match head, near the burner fillers will produce a yellow flame at that point.

**THE PUMP PLUNGER** not only pumps air into the tank but acts as a wrench to turn the air stem. Turned to the left it opens the air stem so air may be forced through check valve. Turned to the right, the air stem closes the check valve and provides a positive shutoff. Air pressure may be added while the stove is burning. Oil the leather occasionally for top efficiency.

**KEEP TANK CLEAN** by rinsing it occasionally with clean fuel.

**BEFORE STORING STOVE,** empty the tank to prevent possible damage from acids, gums, or varnish-like substance which can form in old fuel. Clean the entire stove — burners, tank, case — and it will give you years of dependable service.

**THE STOVE GENERATOR** changes liquid fuel to a vapor. Eventually it may fill with carbon so no fuel can be forced through it. Avoid problems by keeping a spare generator, No. 413A5621 on hand.

**THE GASKET** in filler cap may deteriorate with age. It might be well to install a new No. 118B1361 gasket every year if the old one is hard and brittle.

**CONTACT YOUR DEALER** for service assistance or parts for your stove. Or write The Coleman Co., Inc., mentioning that your stove is a No. 442A.

### YOUR COLEMAN GUARANTEE

All new models of Coleman Outing Products are guaranteed against faulty material or workmanship.

Any part found defective because of imperfect material or workmanship will be replaced without charge when returned with transportation charges prepaid to the Coleman factory, or to the nearest Coleman authorized in-warranty service station.

This guarantee does not, of course, apply to generators on stoves and lanterns, nor to any product where it is evident that damage has developed from improper handling or operation.

**NOTICE:** The use of any attachment or device that is not expressly approved by the Coleman Company, Inc., to alter or affect the operation of the appliance automatically cancels all warranties, implied or expressed. Furthermore, the Company shall not be liable for any consequences that result from the use of equipment under these circumstances.

Coleman's warranty on repair parts is made null and void by their use on other than Coleman<sup>®</sup> manufactured appliances. Coleman's warranty on Coleman<sup>®</sup> appliances is made null and void by use of other than genuine Coleman<sup>®</sup> repair parts.

Always look for this Coleman<sup>®</sup> label.

Made in United States of America

### THE COLEMAN COMPANY, INC.

General Office and Factory: WICHITA 1, KANSAS, U. S. A.

Canadian Office and Factory: Toronto, Canada

1950C804 4-63

Litho. in U. S. A.

P. I.

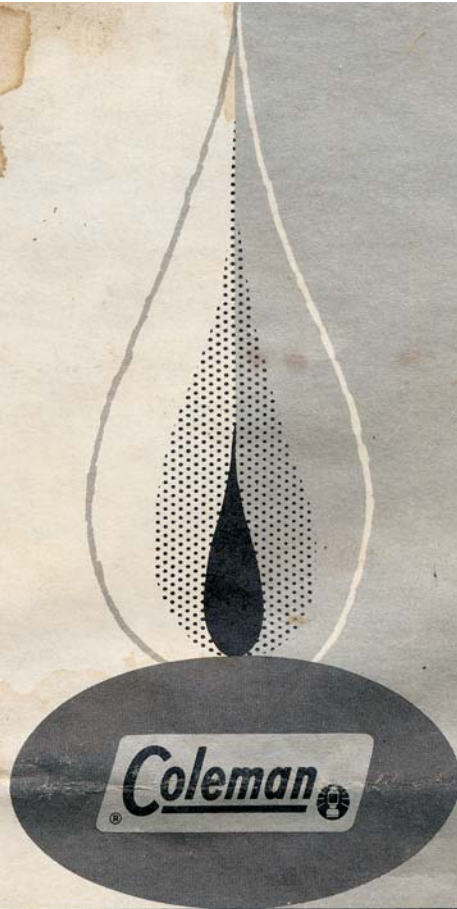

**TWO BURNER  
CAMP STOVE  
442A**

TO OBTAIN SATIS-  
FACTORY RESULTS  
READ AND FOLLOW  
THESE INSTRU-  
CTIONS CAREFULLY  
STEP BY STEP...

\* DIRECTIONS FOR OPERATING AND SERVICING